

Sta-Kon® Terminals



RD, RE, RF stock thickness: .04
RG stock thickness: .05*

Nylon Insulated Ring

Cat. No.	Pkg. Qty.	Wire Range	Max. Ins.	Bolt Hole	Wt./Lbs. Per 1000	Dimensions			
						A	B	C	M
RD167	200	8	.340	#8	12	1.48	.42	.28	1.29
RD8-10	25	8	.340	#10	12	1.48	.42	.28	1.29
RD367	200	8	.340	#10	12	1.48	.42	.28	1.29
RD8-14	25	8	.340	1/4"	12	1.54	.46	.36	1.32
RD717	200	8	.340	1/4"	12	1.54	.46	.36	1.32
RD8-516	25	8	.340	5/16"	12	1.63	.57	.36	1.35
RD727	200	8	.340	5/16"	12	1.63	.57	.36	1.35
RD8-38	25	8	.340	3/8"	12	1.63	.57	.36	1.35
RD737	200	8	.340	3/8"	12	1.63	.57	.36	1.35
RD8-12	25	8	.310	1/2"	12	1.79	.82	.55	1.39
RD757*	200	8	.310	1/2"	12	1.79	.82	.55	1.39
RD10161	200	8AN	.270	#8	12	1.40	.41	.24	1.20
RD10361	200	8AN	.270	#10	12	1.40	.41	.24	1.20
RD10711	200	8AN	.270	1/4"	12	1.45	.45	.34	1.22
RD10721	200	8AN	.270	5/16"	12	1.53	.56	.34	1.25
RD10731	200	8AN	.270	3/8"	12	1.53	.56	.34	1.25
RE6-10	20	6	.420	#10	16	1.65	.49	.28	1.40
RE267	200	6	.420	#10	16	1.65	.49	.28	1.40
RE6-14	20	6	.420	1/4"	16	1.65	.49	.28	1.40
RE717	200	6	.420	1/4"	16	1.65	.49	.28	1.40
RE6-516	20	6	.420	5/16"	16	1.76	.61	.34	1.47
RE727	200	6	.420	5/16"	16	1.76	.61	.34	1.47
RE6-38	20	6	.420	3/8"	16	1.76	.61	.34	1.47
RE737	200	6	.420	3/8"	16	1.76	.61	.34	1.47
RE6-12	20	6	.395	1/2"	16	1.83	.82	.55	1.43
RE757*	200	6	.395	1/2"	16	1.83	.82	.55	1.43
RE10261	200	6AN	.315	#10	16	1.55	.49	.24	1.31
RE10711	200	6AN	.315	1/4"	16	1.55	.49	.27	1.31
RE10721	200	6AN	.315	5/16"	16	1.70	.60	.34	1.40
RE10731	200	6AN	.315	3/8"	16	1.70	.60	.34	1.40
RF4-10	15	4	.510	#10	21	1.76	.56	.36	1.49
RF267	200	4	.510	#10	21	1.76	.56	.36	1.49
RF4-14	15	4	.510	1/4"	21	1.76	.56	.36	1.49
RF717	200	4	.510	1/4"	21	1.76	.56	.36	1.49
RF4-516	15	4	.510	5/16"	21	1.84	.62	.35	1.53
RF727	200	4	.510	5/16"	21	1.84	.62	.35	1.53
RF4-38	15	4	.510	3/8"	23	1.84	.62	.35	1.53
RF737	200	4	.510	3/8"	23	1.84	.62	.35	1.53
RF757*	200	4	.500	1/2"	23	1.90	.82	.55	1.49
RF10261	200	4AN	.380	#10	26	1.78	.55	.30	1.51
RF10711	200	4AN	.380	1/4"	26	1.78	.55	.30	1.51
RF10721	200	4AN	.380	5/16"	26	1.80	.62	.34	1.49
RF10731	200	4AN	.380	3/8"	26	1.80	.62	.34	1.49
RG2-10	10	2	.588	#10	42	2.15	.69	.40	1.83
RG267	100	2	.588	#10	42	2.15	.69	.40	1.83
RG2-14	10	2	.588	1/4"	42	2.15	.69	.40	1.83
RG717	100	2	.588	1/4"	42	2.15	.69	.40	1.83
RG2-516	10	2	.588	5/16"	42	2.15	.69	.40	1.83
RG727	100	2	.588	5/16"	42	2.15	.69	.40	1.83
RG2-38	10	2	.588	3/8"	42	2.15	.69	.40	1.83
RG737	100	2	.588	3/8"	42	2.15	.69	.40	1.83
RG2-12	10	2	.588	1/2"	42	2.35	.80	.49	1.93
RG757	100	2	.588	1/2"	42	2.35	.80	.49	1.93
RG9711	100	1AN	.453	1/4"	48	2.07	.69	.40	1.74
RG9731	100	1AN	.453	3/8"	48	2.07	.69	.40	1.74
RG9751	100	1AN	.453	1/2"	48	2.26	.80	.49	1.84

PDF SUPPORT

K
Sta-Kon®



*Brazed Seam, Lolly-Pop Style Tongue.

AN – Aircraft Wire. U.L. Listed E9809. Installing tools: TBM6/TBM6S, ERG-2007, (RD & RE Except Brazed Seam)
Note: Not available on Mylar Tape.

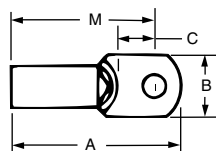

Thomas & Betts